

BUILT UP AREA

TO DWARKA

ROAD 30.0 M R/W

TO PANKHA ROAD  
C-1 JANAK PURI

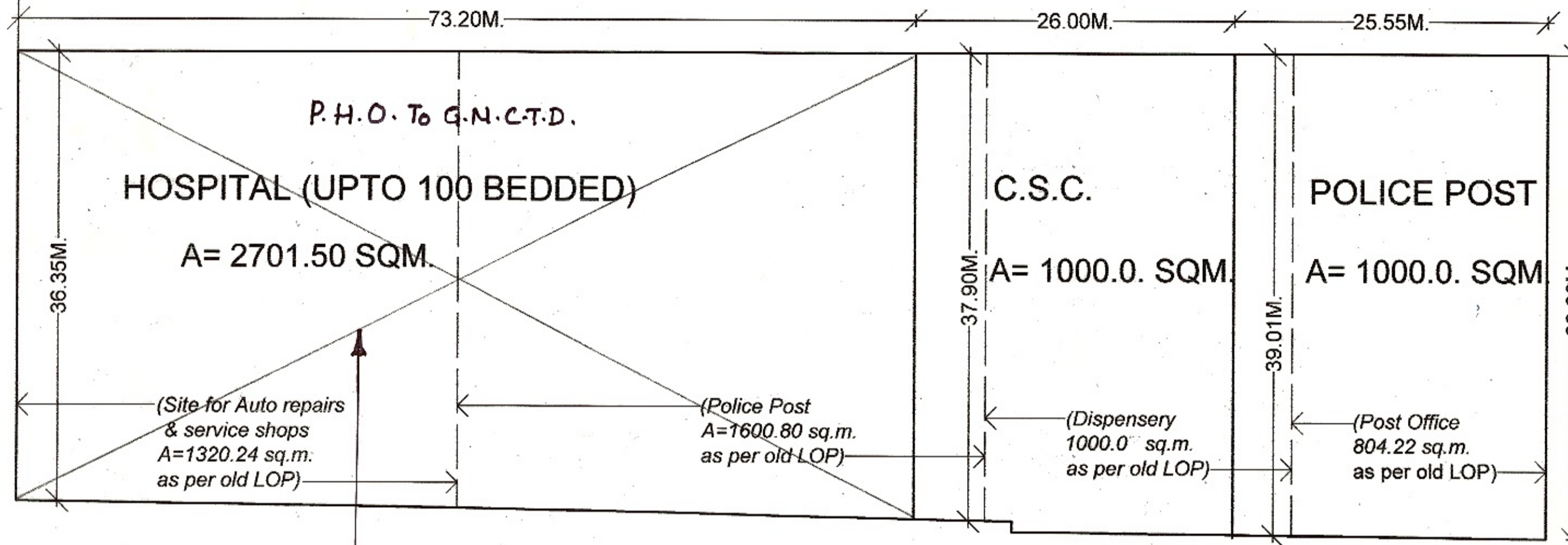

BUILT UP AREA

ALLOTTED TO DIRECTORATE OF HEALTH SERVICES,  
GNCTD ON DATED 22.7.2013 VIDE LETTER  
NO. F.33 (1)90/IL/Pt/2006 DATED 23-8-13  
IN FILE NO. F.1(49)90/PLG/DWK/VOL. II AT PAGE 717/C.

— PLOT BOUNDARY AS PER OLD LOP  
— PLOT BOUNDARY AS PROPOSED

SEWAGE PUMPING STATION

# D. D. A. DWARKA PROJECT

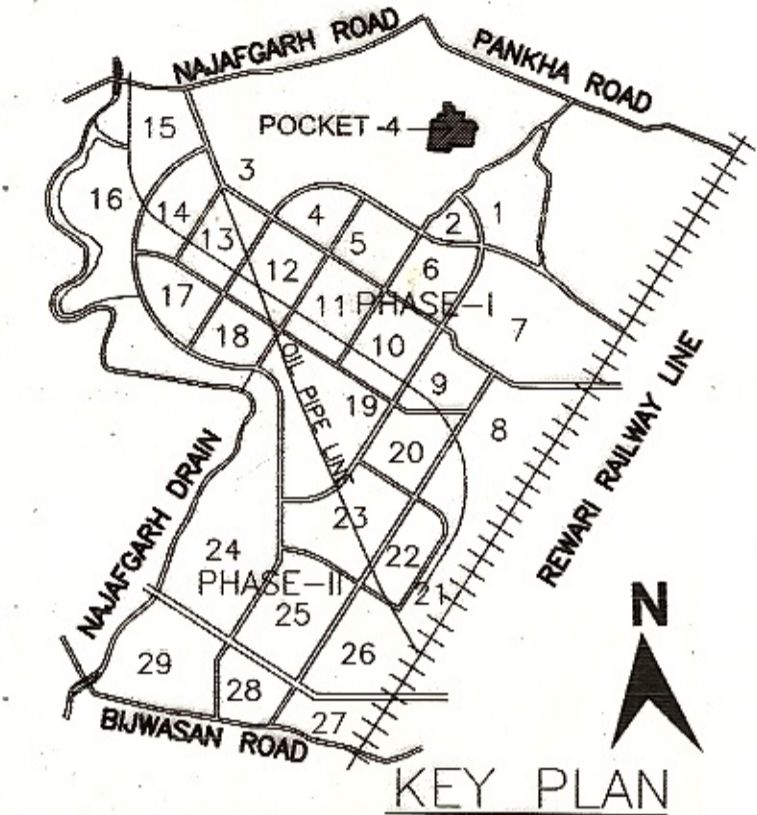

**AREA STATEMENT :-**

TOTAL AREA OF POCKET		: 4701.50 SQ.M
USES	AREA(SQ.M.)	
POLICE POST	1000.00	
C.S.C.	1000.00	
HOSPITAL (UPTO 100 BEDDED)	2701.50	
<b>TOTAL</b>	<b>4701.50 SQ.M.</b>	

**NOTES:-**

1. THE DRG. IS BASED ON P.T. SURVEY PROVIDED BY DY.DIRECTOR(SURVEY)DWARKA IN FILE NO.F.1(49)12-PLG/DWK

THE PROPOSAL WAS DISCUSSED IN THE 307th SCREENING COMMITTEE MEETING HELD ON 02.08.2012 VIDE ITEM NO. 62:2012 AND IT WAS DECIDED THAT THE PROPOSAL BE PUT UP IN SCREENING COMMITTEE AGAIN WITH THE FOLLOWING MODIFICATIONS:

- THE ALLOTMENT OF ESI PLOT BE CANCELED BY THE CLD AND THE PLOT BE MERGED WITH THE HOSPITAL PLOT.
- THE CSC PLOT BE RESIZED WITH AN AREA 1000 SQ.M. OR ABOVE ABUTTING THE HOSPITAL PLOT. IN THE CSC, NO REPAIR SHOPS FOR AUTOMOBILES WILL BE ALLOWED.
- THE PLOT OF POLICE POST WITH AN AREA OF 1000SQ.M. BE SHIFTED TO CORNER.
- AREA OF POLICE POST HAS BEEN REDUCED FROM 1600.80 SQ.MTS TO 1000 SQ. MTS. AND SHIFTED CORNER NEAR SEWAGE PUMPING STATION.
- ESI DISPENSARY ALLOTMENT CANCELLED BY I.L. DEPTT. LETTER NO. F- 33(1)90/IL/Pt DATED 28/9/12 & MERGED WITH HOSPITAL PLOT.
- POST OFFICE & SERVICE ACTIVITIES TO BE ACCOMODATED IN CSC MEASURING 1000SQ.MTS.

APPROVED IN THE 310th SCREENING COMMITTEE MEETING HELD ON 20.12.2012 VIDE ITEM NO. 142:2012 IN FILE NO. F.1(49)2012/PLG./ DWK.

SECOND PARTIAL MODIFICATION IN THE LAYOUT PLAN OF ISOLATED POCKET -4 BINDAPUR, DWARKA, ZONE K-II. AS PER DECISION OF 307th SCM DATED 2/8/12

SCALE : 500	DRG. NO. DWK/BINDAPUR,PKT.4/PART PLAN/DEC.12/ 92
PLG. ASSTT.	DATE 27-07-12
ASSTT. DIR. ( PLG.)	DY. DIRECTOR (PLG.)
DIRECTOR ( PLG.)	
<b>DELHI DEVELOPMENT AUTHORITY</b>	